

V3A8MT Digital Lock

User Manual

*Focus on Smart Lock
Since 1992*



IMPORTANT SAFETY INSTRUCTIONS

Please read the following safety instructions to prevent any accident, property damage and inconvenience. Children should be well educated for the operating instruction. Keep this manual in a convenient place so that you can refer to it when necessary.



Caution Must be followed to protect yourself and your property.

Note

Explains product functions and features.



Prohibited



Must observe



Caution



Do not use an inappropriate tool that can cause damage or malfunction of the product.

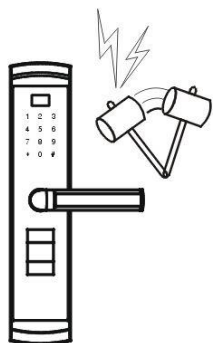

Handle the unit with care. Excessive force, careless handling may cause product damage.

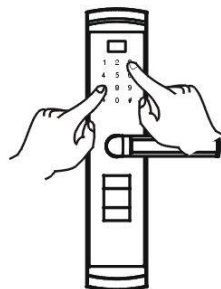

Be careful not to have an unauthorized user know your security code. Change your code periodically.

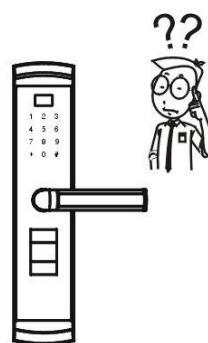

Do not use water and any type of solvent such as gasoline or benzene as they can cause damage to electronic circuit.

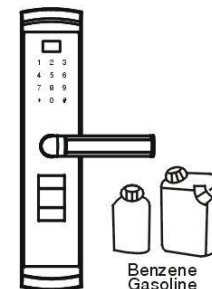

Do not have your card key lost or stolen.

- Immediate re-registration of all remaining keys is required to invalidate the lost key.



Educate your children about the proper use of the product.

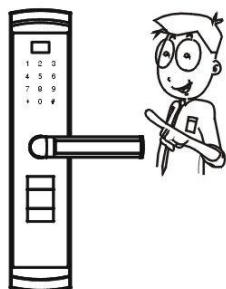

Make sure the door is securely locked whenever you leave your house, especially in the manual lock mode.

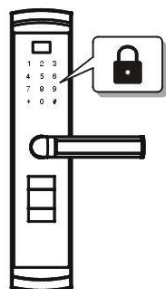

Keep card key reader part clean and dry. Dust off dirt smoothly with a soft cloth.

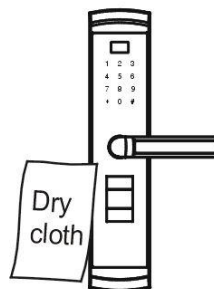

Remove all of the batteries before installing or removing a remote control module.

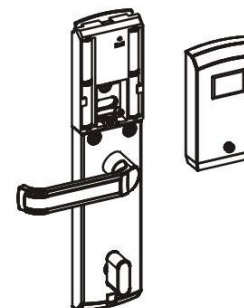

1 Specifications

2 Identification of Product

3 How to use

- 1.Reset the lock
- 2.Registering Master key
- 3.Registering User key
- 4.Program User code
- 5Automatic/Manual Lock Mode
- 6.Dual Authentication/Normal mode
- 7.Locking the door from the outside
- 8.Unlocking the door from the outside under Normal mode
- 9.Unlocking the door from the outside under Dual Authentication mode
- 10.Unlocking the door from the inside
- 11.Wrong-try Lock-out
- 12.Battery use & Replacement

4 Cautions

- 1.For a stolen or delete some User key
- 2.For deleting all User keys at a time
- 3.For deleting or changing User codes
- 4.Scramble code
- 5.Emergency mechanical key override.

1 Specifications

Parts	Specifications	Remarks
Front(Front Body)	72(W)x333(H)x21(D)mm, Zinc Alloy	Operating temperature:-10~55 ° C
Back(Back Body)	79(W)x333(H)x25(D)mm, Zinc Alloy	
Handle	Zinc Alloy	
Master Key	Setting Function Unlock/Lock	1 Master key
User Keys	Unlock/Lock	19 User keys A and 20 User keys B
User Codes	Unlock/Lock	10 Groups (4~9 Digits)
Battery	4 EA 1.5V AA alkaline batteries (Operating voltage:4.2~6.4V)	Last up to 12 months(10 times used a day)
Lock case	Stainless Steel	

※Battery life may vary depending on temperature, moisture levels, frequency of use and the quality of the batteries.

※Please make sure that all parts are included when purchasing the product.

※Optional products may not be available depending on your country or local dealer.

■ Basic Contents



Front Lock



Back Lock



Mortise

- Emergency keys
- Screws
- Installation Template
- Users Manual

2 Identification of Product

1.Front (Front Body, install on the outside of the door)

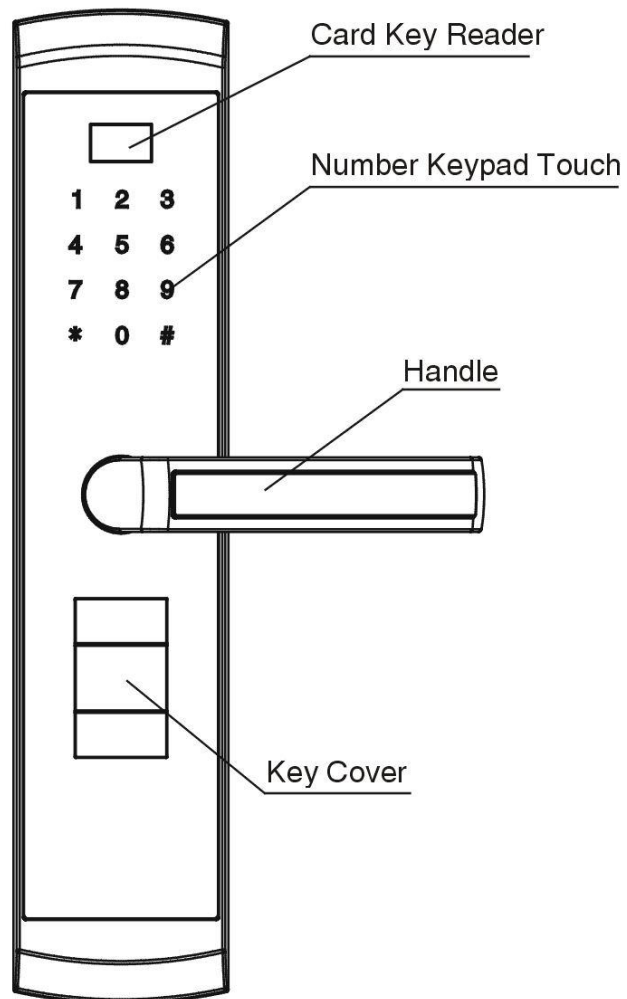

Take out key cover

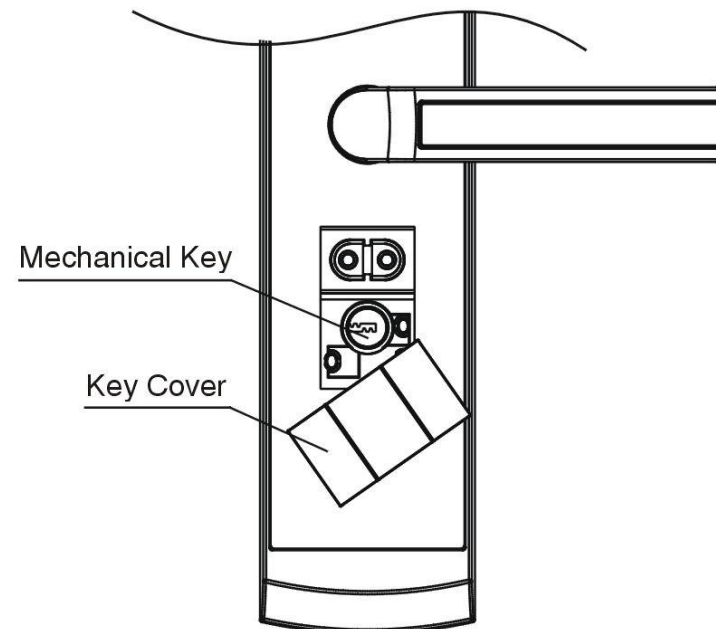

2.Back (Back Body, install on the inside of the door)

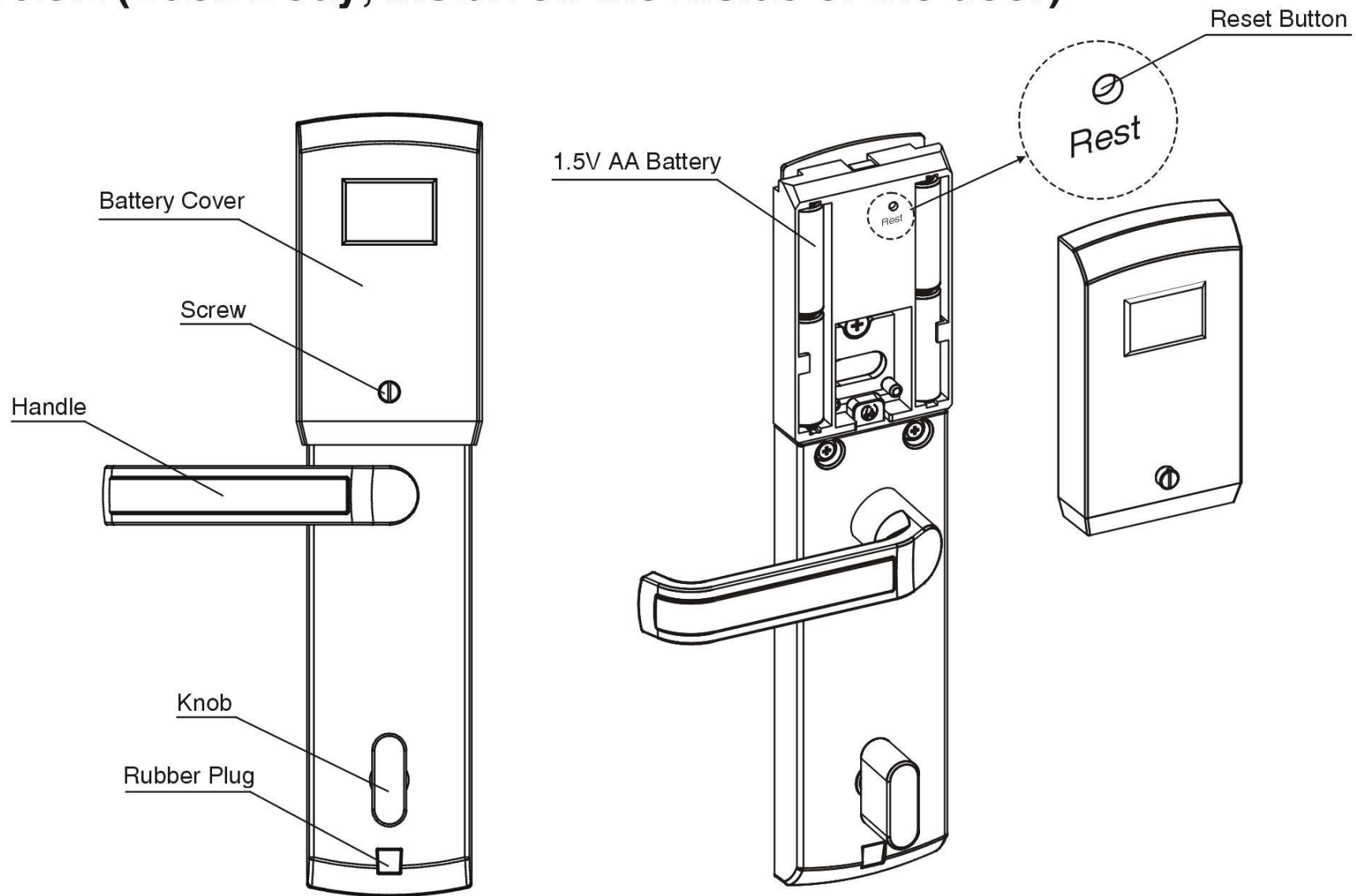

3 How to Use

1. Reset the lock

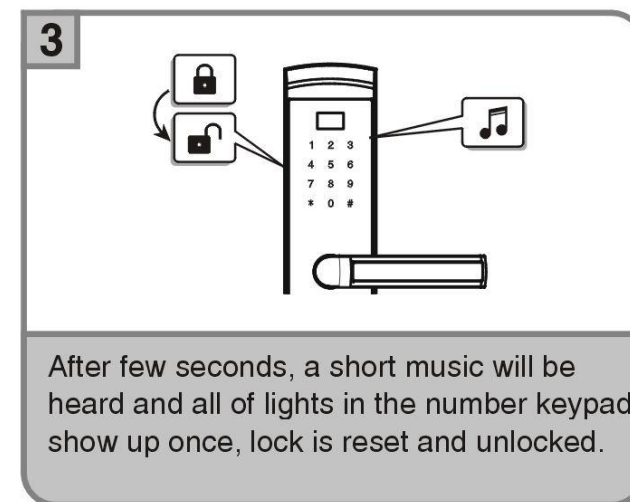
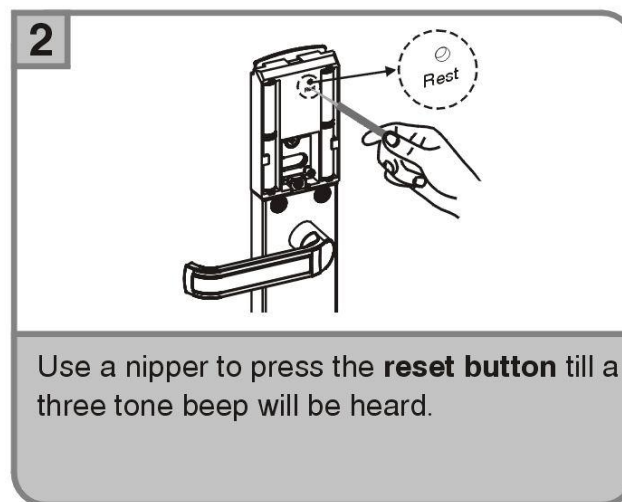
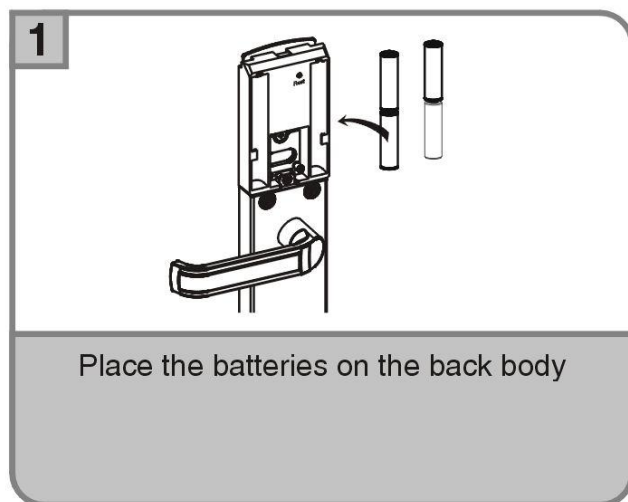

Note

- The lock will be factory setting (Automatic mode and Normal mode) after resetting.

2. Registering Master key



Caution

- Keep the door open while you set Master key to prevent yourself from accidentally getting locked out.

1

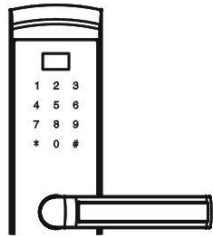

After resetting the lock.

2

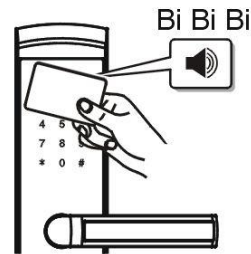

Tap key you want to register as a master key on the lock, a three tone beep will be heard. **The Master key is set.**

3

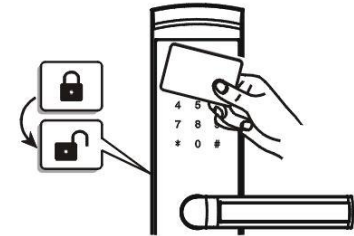

Check the key operation opening the door with your card key, **tap your card key to card key reader.**

Note

- Only one Master key is accepted by the lock.
- It will become locked state when tap the Master key on the lock first time.

3. Registering User key



Caution

- Keep the door open while you set the User key to prevent yourself from accidentally getting locked out.

Note

- It can be set at least 39 user keys (19 User keys A and 20 User keys B) in total.
- It is able to register User keys while the 1 or 2 lights in the number keypad is flashing.
- Both User key A and User key B can unlock the lock.

1

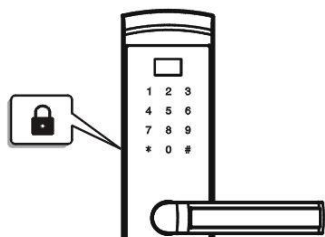

Go to the lock that has been registered with existing Master key and under locked state.

2

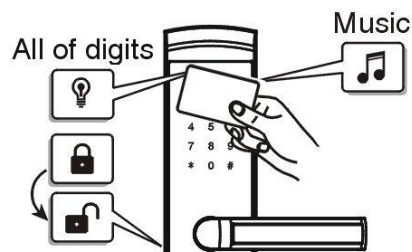

Tap Master key on the lock, a short music will be heard and all of lights in the number keypad show up once. The lock is unlocked.

3

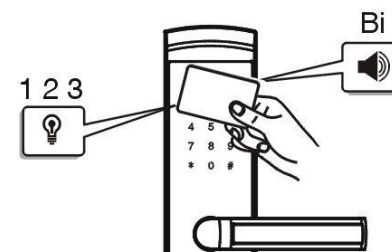

Tap Master key again within 4 seconds, a single tone beep will be heard and you will see 1, 2, 3 lights in the number keypad show up.

4

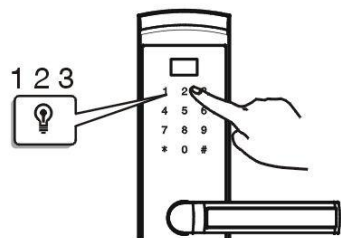

While the 1, 2, 3 lights in the number keypad show up, **press "1" (for key A) or "2" (for key B)**.

5

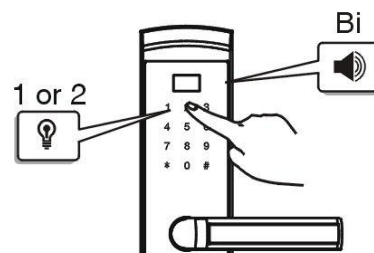

While the 1 (for key A) or 2 (for key B) lights in the number keypad is flashing. **Tap the key you want to set on the lock**, a single tone beep will be heard and the 1 or 2 lights in the number keypad keep flashing. **The User key is set.**

6

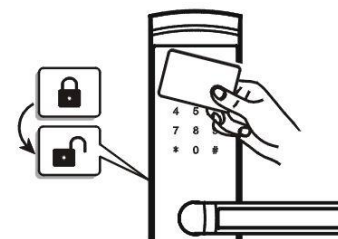

Check the key operation opening the door with your card key, **tap your card key to card key reader**.

4.Program User code



Caution

- Keep the door open while you set User code to prevent yourself from accidentally getting locked out.

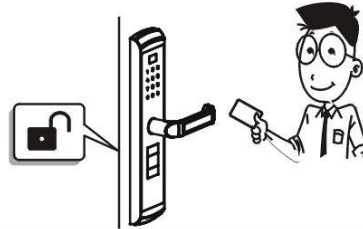

Note

- It can be set at least 10 User codes in total, so User codes can be register by a lock.
- It is able to register User codes while all of lights in the number keypad show up.

1

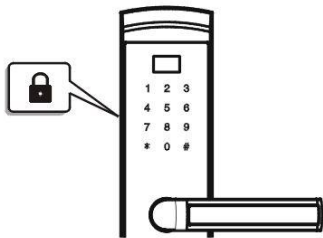

Go to the lock that has been registered with existing Master key and under locked state.

2

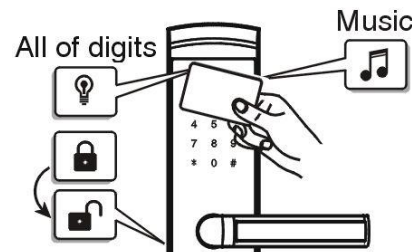

Tap Master key on the lock, a short music will be heard and all of lights in the number keypad show up once. The lock is unlocked.

3

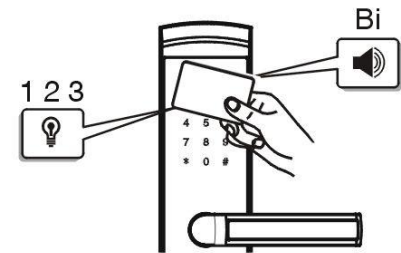

Tap Master key again within 4 seconds, a single tone beep will be heard and you will see 1、2、3 lights in the number keypad show up.

4

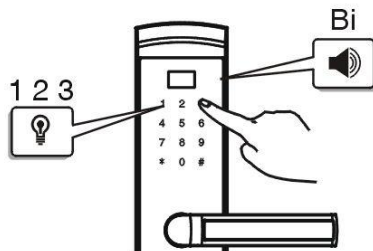

While the 1、2、3 lights in the number keypad show up, **press "3"**.

5

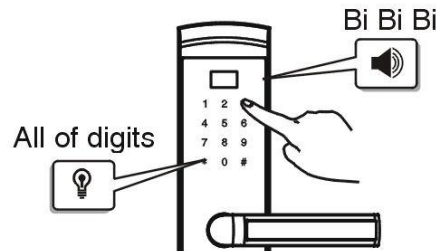

While all of lights in the number keypad show up once, **enter the code (4~9 digits) you want to set and press # button**, a three tone beep will be heard. **The User code is set.**

6

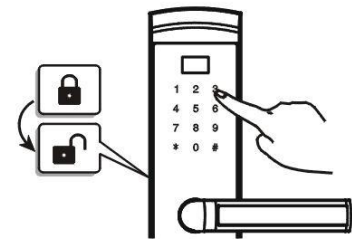

Check the key operation opening the door with your user code, **enter your User code +#**.

5. Automatic/Manual Lock Mode



Caution

Automatic lock mode is a factory default setting, and it will automatically lock in 4 seconds.

Setting Manual lock mode

If the lock is under **Automatic** lock mode

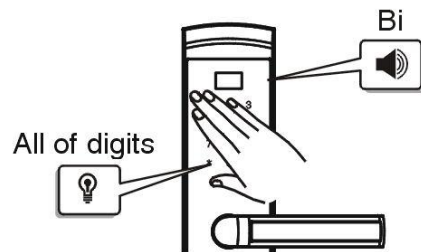

Touch number pad, a single tone beep will be heard and all of lights in the number keypad show up once.

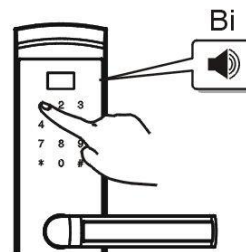

While one of digit randomly light up
Press "1" for four seconds, a single tone beep will be heard.

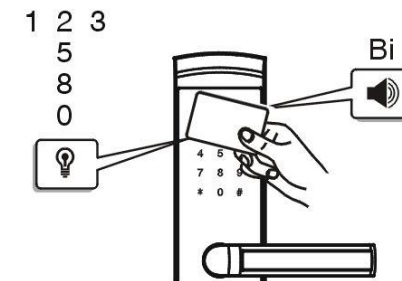

Tap Master key on the lock, a single tone beep will be heard and 1、2、3、5、8、0 lights in the number keypad show up once (it will display T shape). **The lock is set to Manual lock mode.**

Setting Automatic lock mode

If the lock is under **Manual** lock mode



Touch number pad, a single tone beep will be heard and all of lights in the number keypad show up once.

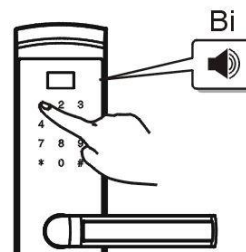

While one of digit randomly light up
Press "1" for four seconds, a single tone beep will be heard.

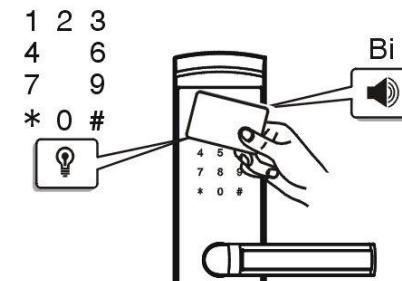

Tap Master key on the lock, a two tone beep will be heard and 1、2、3、4、6、7、9、*、0、# lights in the number keypad show up once (it will display O shape). **The lock is set to Automatic lock mode.**

6. Dual Authentication/Normal mode

If the lock is under Normal mode

1

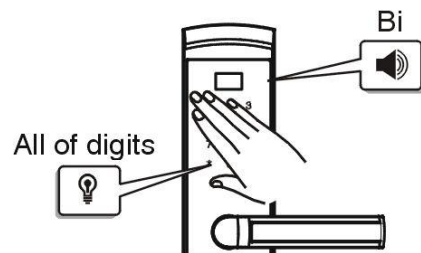

Touch number pad, a single tone beep will be heard and all of lights in the number keypad show up once.

2

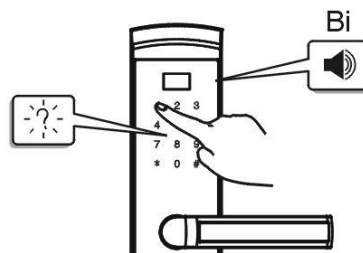

Two buttons randomly light up, **press two numbers in sequence**.

3

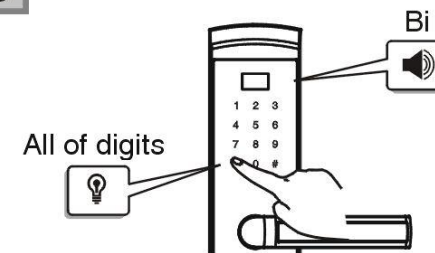

While all of lights in the number keypad show up, **press "*" for four seconds**, a single tone beep will be heard and all of lights in the number keypad show up.

4

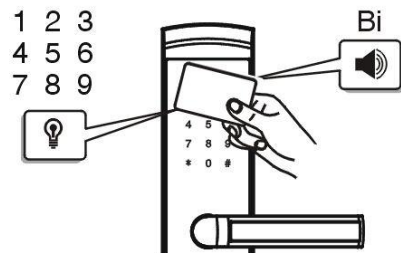

Tap Master key on the lock, a single tone beep will be heard and 1、2、3、4、5、6、7、8、9 lights in the number keypad are flashing twice. The lock is set to Dual Authentication mode.

If the lock is under Dual Authentication mode

1

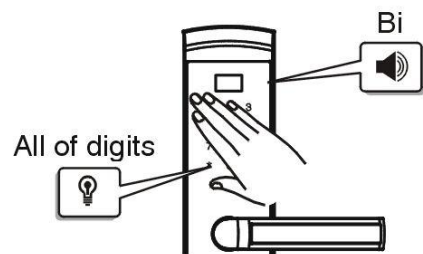

Touch number pad, a single tone beep will be heard and all of lights in the number keypad show up once.

2

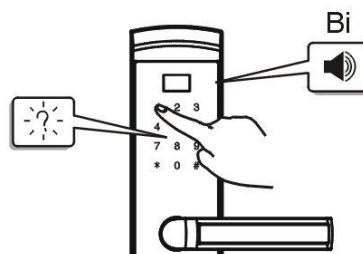

Two buttons randomly light up, **so press two numbers in sequence**.

3

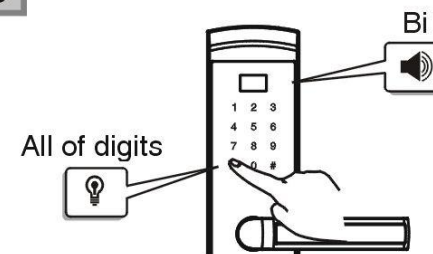

While all of lights in the number keypad show up, **press "*" for four seconds**, a single tone beep will be heard and all of lights in the number keypad show up.

4

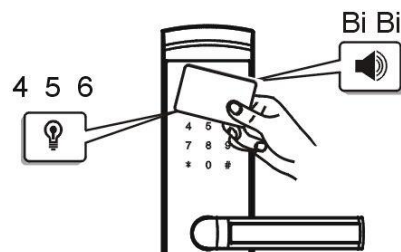

Tap Master key on the lock, a two tone beep will be heard and 4, 5, 6 lights in the number keypad show up once. the lock is set to Normal mode.

7.Locking the door from the outside

※ Please check Automatic/Manual Lock mode

Under Automatic lock mode

When you unlock the lock, a short music will be heard and all of lights in the number keypad show up once, the lock will lock automatically within 4 seconds.

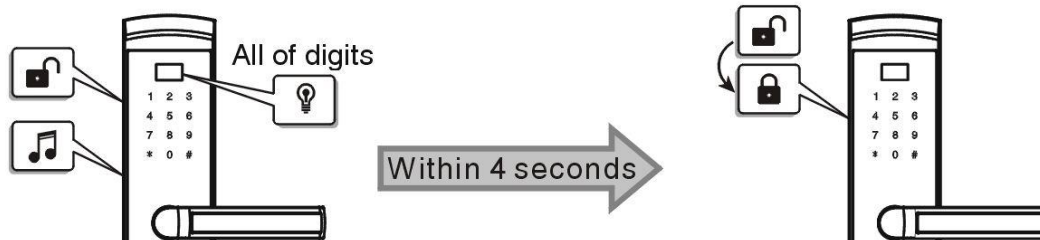

Under Manual lock mode

Tap User key, a short music will be heard and all of lights in the number keypad show up once. Lock is locked.

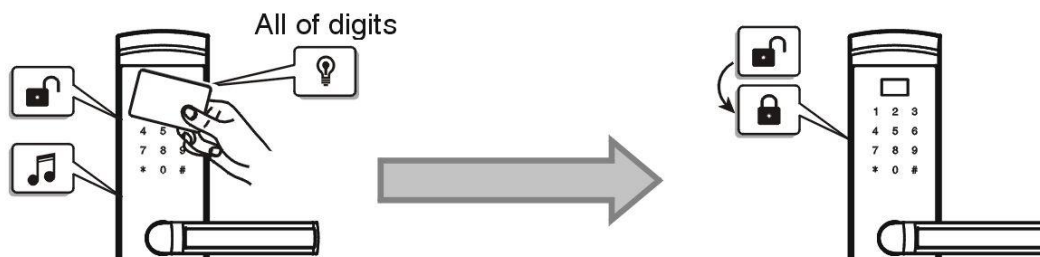

Touch number pad, a single tone beep will be heard and all of lights in the number keypad show up once.

Two buttons randomly light up, **press two numbers in sequence and press "#"**. Lock is locked.

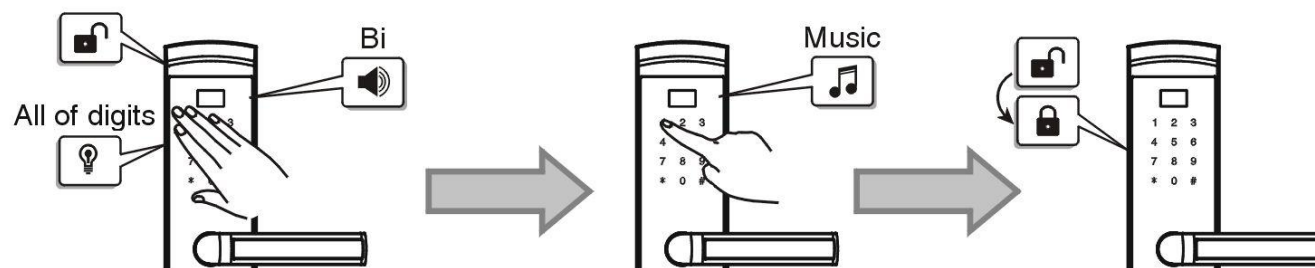

⚠ Caution

- As the automatic lock function does not work in manual lock mode, make sure to check the door is securely locked when leaving the premises.

8.Unlocking the door from the outside under Normal mode

Unlocking the door with User code

1

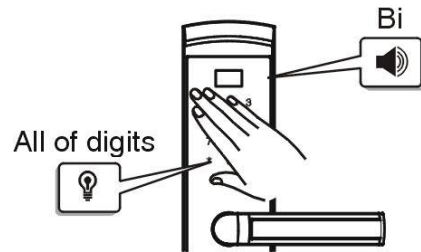

Touch number pad, a single tone beep will be heard and all of lights in the number keypad show up once.

2

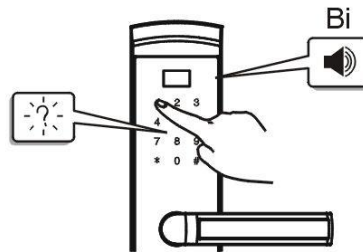

Two buttons randomly light up, **press two numbers in sequence**.

3

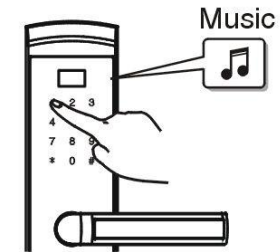

While all of lights in the number keypad show up, **enter user code + #**.

4

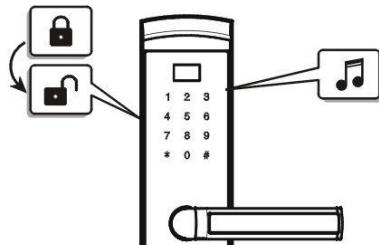

Confirming the door open.

Unlocking the door with User key

1

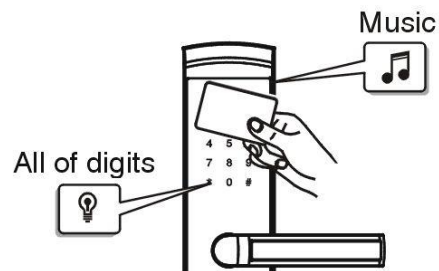

Tap User key on the lock, a short music will be heard and all of lights in the number keypad show up once.

2

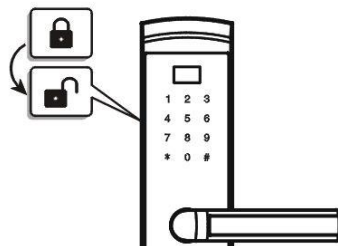

Confirming the door open.

9.Unlocking the door from the outside under Dual Authentication mode

Unlocking the door with two different groups of User key

1

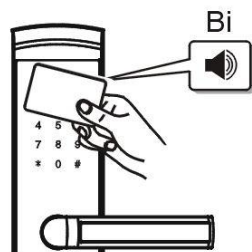

Tap one of User key A on the lock, a single tone beep will be heard.

2

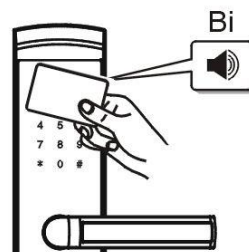

Tap one of User key B on the lock, a short music will be heard and all of lights in the number keypad show up once.

3

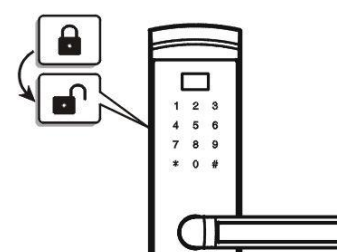

Confirming the door open.

Unlocking the door with two different group of User codes

1

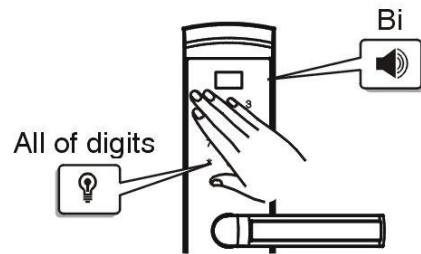

Touch number pad, a single tone beep will be heard and all of lights in the number keypad show up once.

2

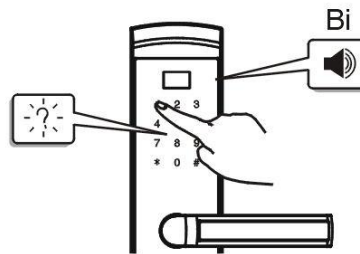

Two buttons randomly light up, **press two numbers in sequence**.

3

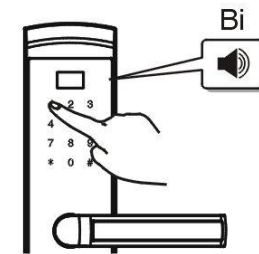

While all of lights in the number keypad show up, **enter user code + #**.

4

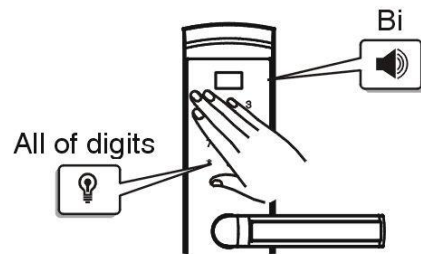

While all of lights in the number keypad is off, **touch number pad again**, a single tone beep will be heard and all of lights in the number keypad show up once.

5

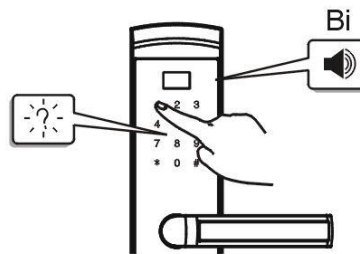

Two buttons randomly light up, **press two numbers in sequence**.

6

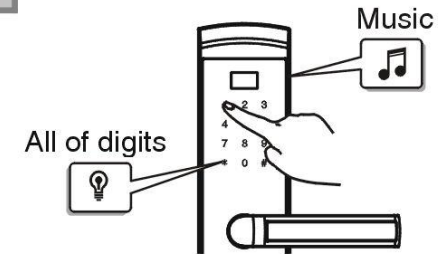

While all of lights in the number keypad show up once, **enter another code + #**. a short music will be heard and all of lights in the number keypad show up once.

Unlocking the door with two different group of User codes

7

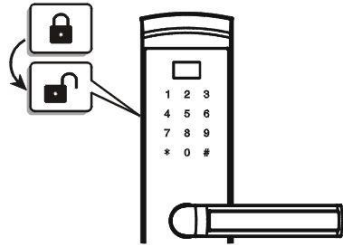

Confirming the door open.

Unlocking the door with User code and User key

1

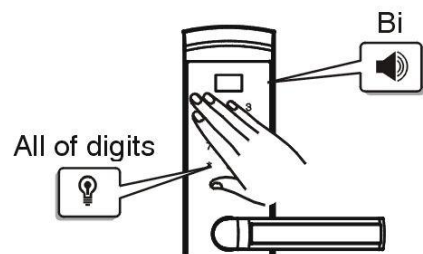

Touch number pad, a single tone beep will be heard and all of lights in the number keypad show up once.

2

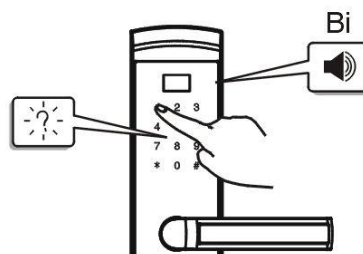

Two buttons randomly light up, **press two numbers in sequence**.

3

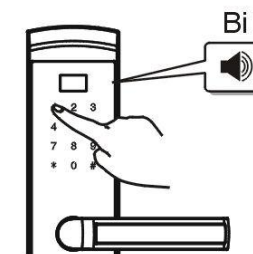

While all of lights in the number keypad show up, **enter user code + #**.

4

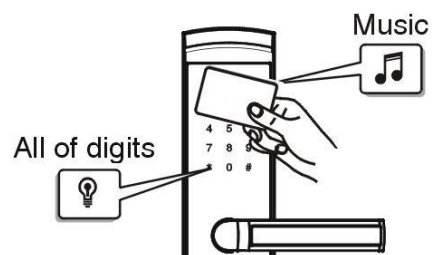

While all of lights in the number keypad is off, **tap a user key on the lock**, a short music will be heard and all of lights in the number keypad show up once.

5

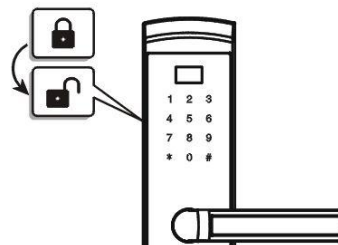

Confirming the door open.

10.Unlocking the door from the inside

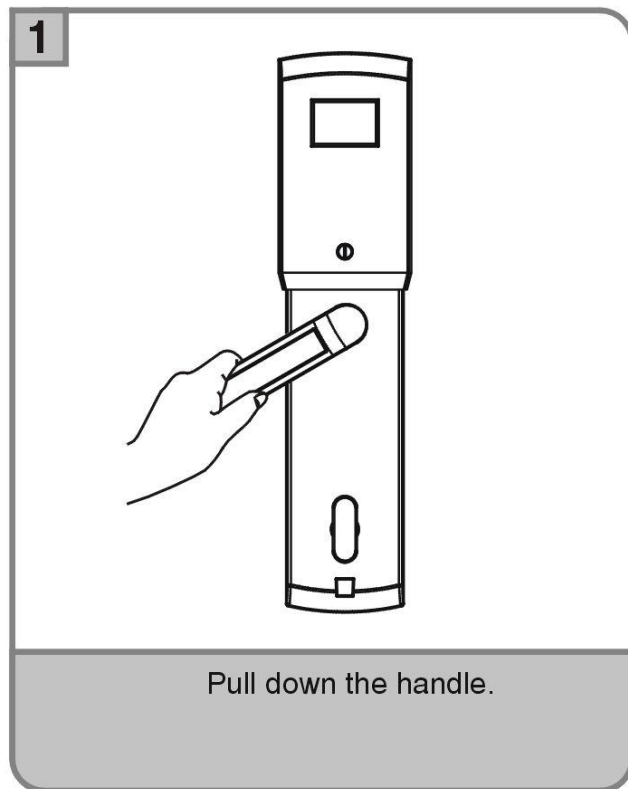

11. Wrong-try Lock-out

If incorrect User key are attempted 3 times in a row, it will lock-out about 2 minutes with flashing red LED light.

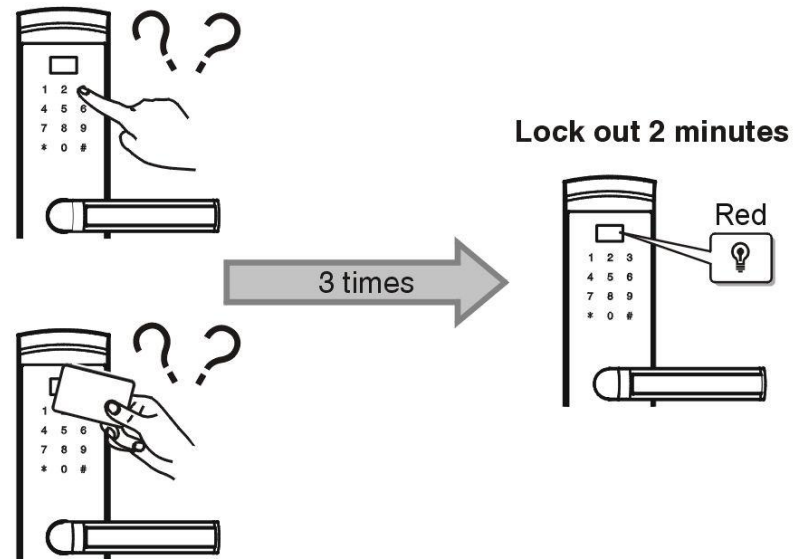

This system will resume the operation automatically after 2 minutes of lock-out.

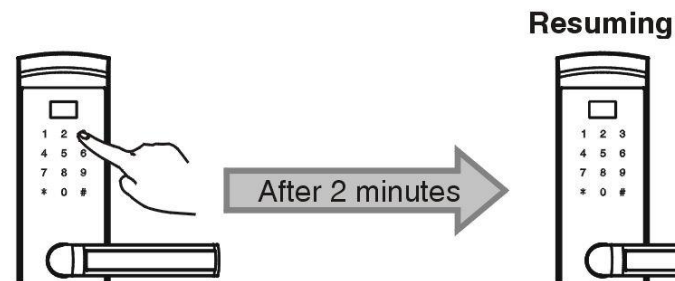

12. Battery use & Replacement.

This product uses 4 1.5V alkaline AA batteries which can be used approximately one year on the condition of 10 times open/close cycles per day.

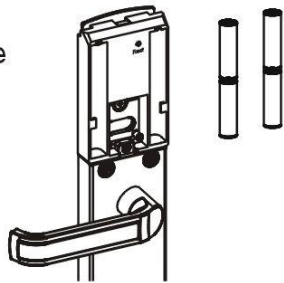

Battery life may vary due to temperature moisture, frequency of use and the quality of the batteries.



Battery replacement warning

Replace all 4 batteries when a low battery warning sound rings and red LED light under unlock the lock.



Extremely low voltage

The red Led light will flash once in every 5s which is indicating extremely low voltage. It will be resumed after changing new battery and unlock.

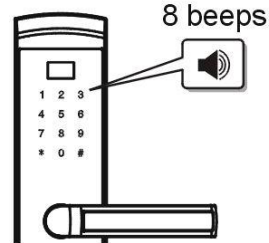

The low voltage alarm 8 beeps when open the lock.

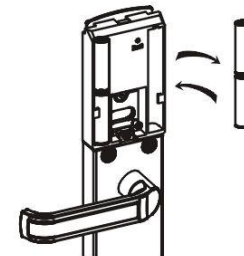

Do not mix new and used batteries.



Caution

- Always check ' + ' and ' - ' directions when inserting batteries.
- Use the authentic alkaline batteries. It is an user's responsibility for damage caused by using unauthentic batteries.
- Risk of explosion if battery is replaced by an incorrect type.
- Dispose of used batteries according to the instructions.

1



2

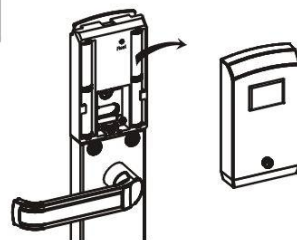

3

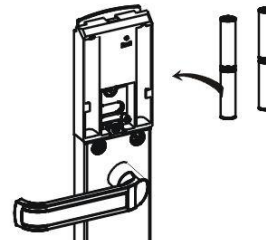

4

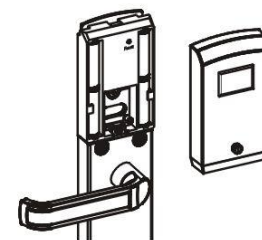

4 Cautions

1. For a stolen or delete some User key

1

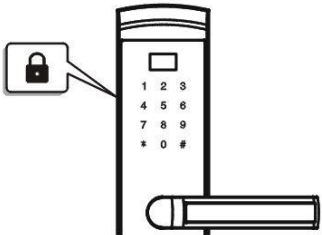

Under locked state

2

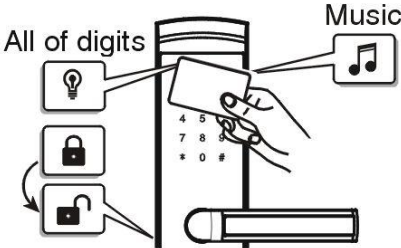

Tap Master key on the lock, a short music will be heard and all of lights in the number keypad show up once. The lock is unlock.

3

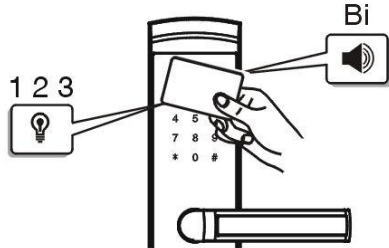

Tap Master key again, a single tone beep will be heard and you will see 1、2、3 lights in the number keypad show up.

4

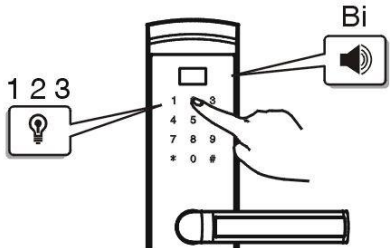

While the 1、2、3 lights in the number keypad show up, **press "1" (for key A) or "2" (for key B) you want to delete.**

5

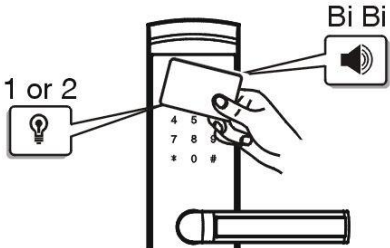

While the 1 (for key A) or 2 (for key B) lights in the number keypad is flashing. **Tap key (A or B) on the lock**, a two tone beep will be heard and the 1 or 2 lights in the number keypad keep on flashing. **The User key is deleted.**

Note

- It is able to delete other programmed User key by tapping the card while the corresponding of digits is flashing.

2. For deleting all User keys at a time

1

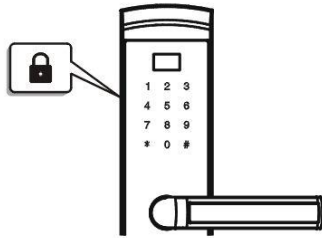

Under locked state

2

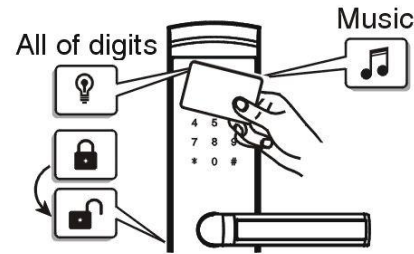

Tap Master key on the lock, a short music will be heard and all of lights in the number keypad show up once. The lock is unlock.

3

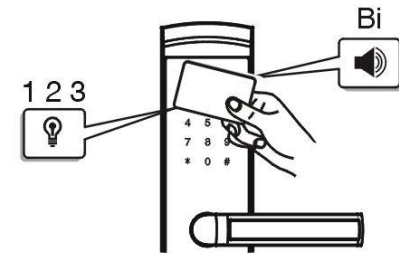

Tap Master key again, a single tone beep will be heard and you will see 1、2、3 lights in the number keypad show up.

4

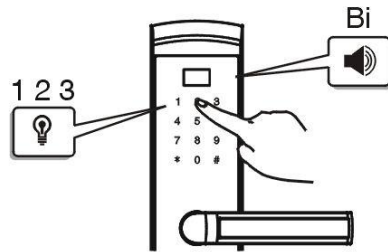

While the 1、2、3 lights in the number keypad show up, **press "1"(for key A) or "2" (for key B) button you want to delete.**

5

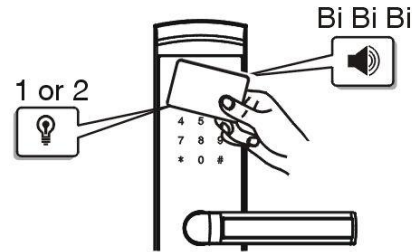

While the 1(for key A) or 2(for key B) lights in the number keypad is flashing. **Tap Master key on the lock**, a three tone beep will be heard. **All of User keys(A or B) are deleted.**

Note

- It is able to delete other programmed User key by taping the card while the corresponding of digits is flashing.

3. For deleting or changing User codes

1

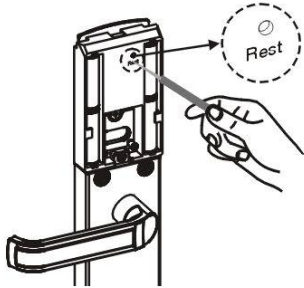

In case that you want to delete or change the User codes, you have to reset the lock.

Note

- If reset the lock, all of keys including master key and user keys will be deleted, then you have to setup this lock again.

4.Scramble code

You can enter meaning less number prior to the right code when there is chance of exposing it to others, but the total numbers should be less than 20 digits, otherwise it would be error.

5.Emergency mechanical key override

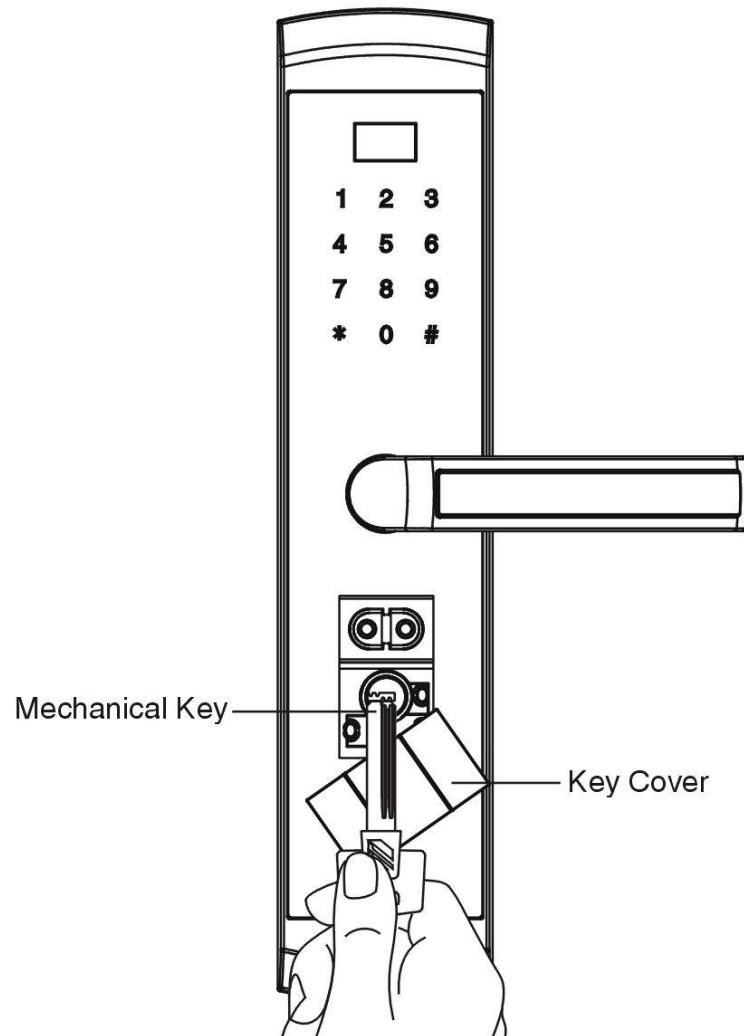

LED Light Indication introduction

Successful operation	Blue light flashes once
Wrong operation	Red light flashes once
Low voltage warning	Red light flashes 8 times
Unlock	Blue light flashes once
Lock	Blue light flashes once
Incorrect code	Red light flashes 4 times
Incorrect code operates thrice	Red light flashes 60s

Smart Your Life

GUANGDONG BE-TECH SECURITY SYSTEMS LIMITED

Add: No.17, Keyuan 3 Road, Ronggui, Shunde High-Tech Zone, Foshan,
Guangdong, P.R.China.

Tel: 86-757-2830 88333 Fax: 86-757-2830 8823

<http://www.be-tech.com.cn>

Email: export@be-tech.com.cn